

WP-0032
3/09/2009

Economy Size Luggage Box Installation

Luggage Box Installation

(This box fits all models except the Alta 49 & Sport 150 models)

Remove mounting hardware from inside luggage box.

Note: The Keys for the lock are taped to the poly bag that the box is wrapped in. **DO NOT** discard any packing material until you have completed the installation.

Beamer Luggage Box Contents

Ref #	Description	Qty
(1)	Luggage Box	1
(2)	Keys	2
(3)	Box pad	1
(4)	Mounting Bolts	4
(5)	Mounting Tabs	2
(6)	Nuts	4
(7)	Mounting plate	1
(8)	Washers	8

With the lid open, set the rear luggage box **(1)** onto the carrier rack at the back of the bike.

Place the mounting plate **(2)** on the bottom inside of the box. Install the four bolts **(4)** and four washers **(3)** through the mounting plate and luggage box as shown in the diagram.

Install the mounting tabs **(5)** underneath the carrier rack on the back of the bike. Install the remaining washers and the nuts **(6)** on the ends of the bolts.

Center the luggage box on the carrier before tightening the nuts on the ends of the bolts to hold the box in place.

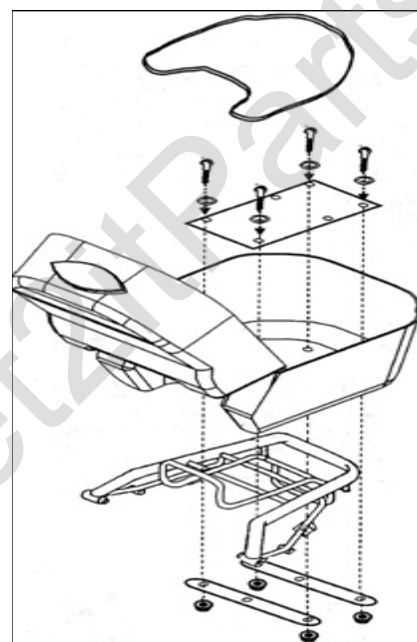
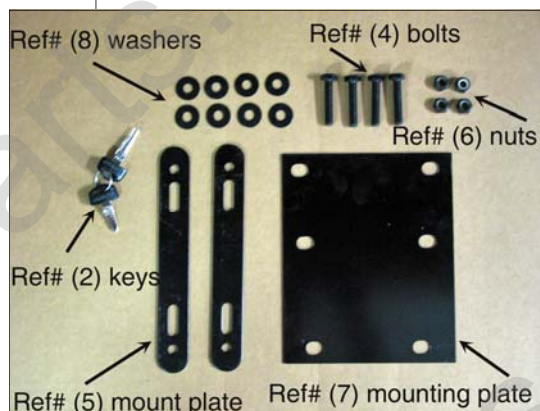

ETON America, LLC