

WP-0019
10/01/2005

Scooter Luggage Box Installation

Luggage Box Installation (Beamer Matrix & Optional Beamer II/III only)
For (Optional) SPORT Scooter Installation, go to PAGE 4

Remove mounting hardware from inside luggage box.

*Note: the Key for the lock maybe taped to the poly bag the box is wrapped in. **DO NOT** discard any packing material until you have completed the installation.*

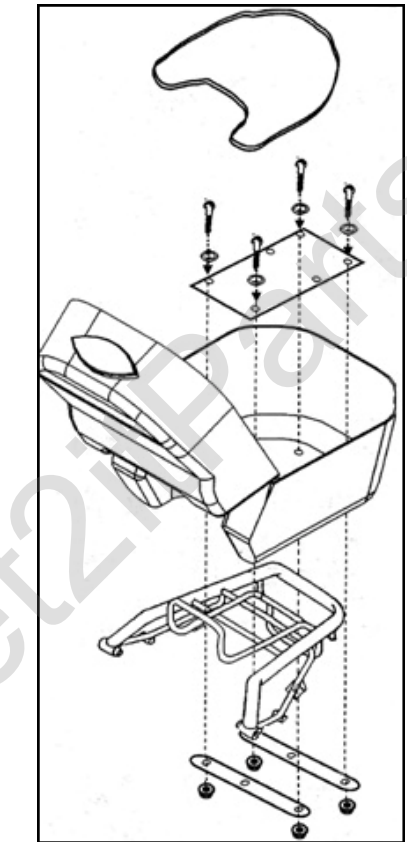
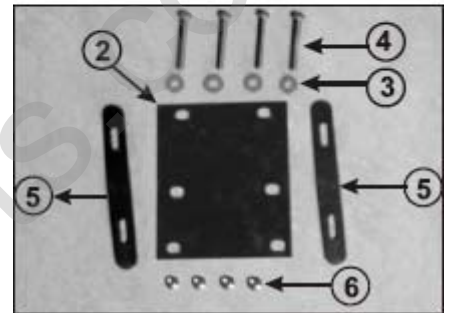

Beamer Luggage Box Contents		
Ref #	Description	Qty
(1)	Luggage Box	1
(2)	Mounting Plate	1
(3)	Washer	8
(4)	Mounting Bolts	4
(5)	Mounting Tabs	2
(6)	Nuts	4
(7)	LED Wire - Attached to (1)	1
(8)	Box Pad	1
(9)	Key (Not shown)	2

With the lid open, set the rear luggage box (1) onto the carrier rack at the back of the bike.

Place the mounting plate (2) on the bottom inside of the box. Install the four bolts (4) and four washers (3) through the mounting plate and luggage box as shown in the diagram.

Install the mounting tabs (5) underneath the carrier rack on the back of the bike. Install the remaining washers and the nuts (6) on the ends of the bolts.

Center the luggage box on the carrier before tightening the nuts on the ends of the bolts to hold the box in place.

Run the LED wire (7) through the bottom opening of the luggage box. Plug the wires into the harness at the right hand rear of the bike. No splicing is necessary when installing.

Note: the wires are usually tucked underneath the rear fender just above the DOT plate.

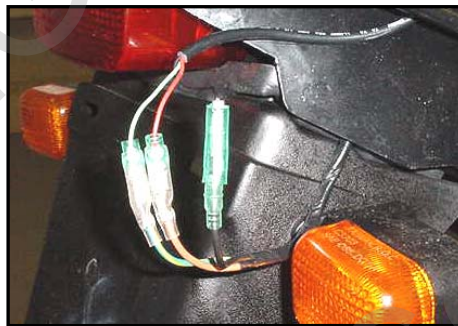

Metal Mounting Plate Option



ETON America, LLC

WP-0019
10/01/2005

Scooter Luggage Box Installation

FIG #1



1st check the contents of package

- 1-Luggage box
- 1-Set of keys
- 1-Mounting plate
- 1-Luggage box pad
- 4-Mounting brackets
- 4-Bolts
- 4-Washers
- 4-Nuts

FIG #3



FIG #2



The mounting plate is positioned on the bottom of the luggage box with the smooth side toward the box. The (4) bolts and washers are pushed through the box and plate from inside the box using the holes indicated in Fig #3.

Place the box and plate over the rear rack and attach using the (4) brackets, washers and nuts supplied. See Fig #4.

FIG #4



Hi Impact Composite Mounting Plate Option



ETON America, LLC

WP-0019
10/01/2005

Scooter Luggage Box Installation

Fig #5

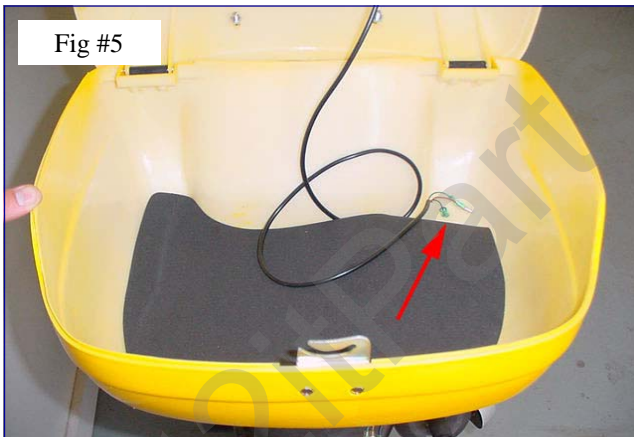

Once the luggage box is installed push the rear brake light LED wires through the hole in the box as shown in Fig #5 and install the luggage box pad.

Fig #6



The wires for the LED hookup are located on the rear of the bike around the rear taillight. They may be tucked in under the harness on the left hand side of the unit..

Note: ONLY the Beamer II & III and the Matrix & Matrix II have been pre wired for the luggage box brake light.

If you have the older model Beamer the LED will have to be hard wired into the rear taillight.

Fig #7



Connect the wires from the LED light to the main harness using the following wiring table.:

Box Wires	Main Harness
Red	Brown
Green	Green
Black	Black



ETON America, LLC

WP-0019
10/01/2005

Scooter Luggage Box Installation

E-TON SPORT Scooter Series Installation



1st check the contents of package
1-Luggage box
1-Set of keys
1-Mounting plate
1-Luggage box pad
4-Mounting brackets
4-Bolts
4-Washers
4-Nuts

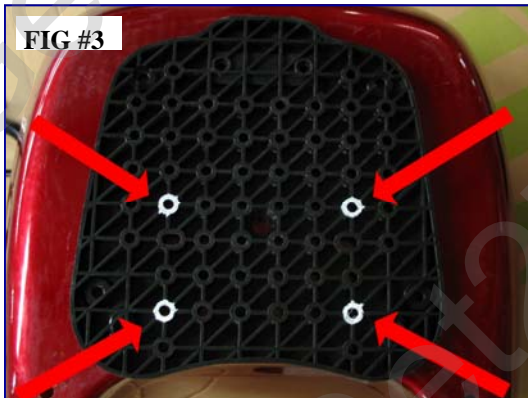

FIG #2

The mounting plate is positioned on the bottom of the luggage box with the smooth side toward the box. The (4) bolts and washers are pushed through the box and plate from inside the box using the holes indicated in Fig #3.

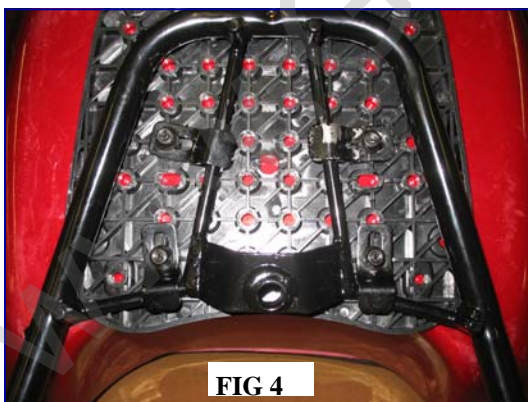

FIG 4

Place the box and plate over the rear rack and attach using the (4) brackets, washers and nuts supplied. See Fig #4.



ETON America, LLC

WP-0019
10/01/2005

Scooter Luggage Box Installation



Once the luggage box is installed push the rear brake light LED wires through the hole in the box as shown in Fig #5 and install the luggage box pad.

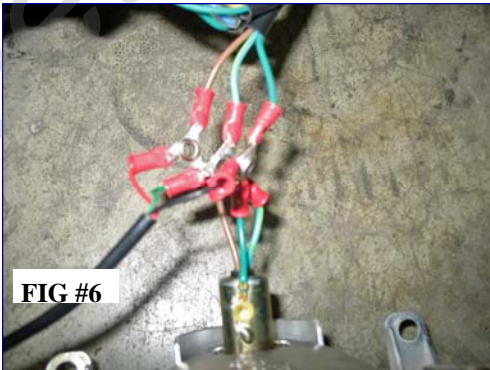

Note: This bike is not pre wired for the taillight on the luggage box. You will have to hard wire the luggage box taillight into the rear taillight of the bike. This may require removal of the rear plastics.

Connect the wires from the LED light To the rear taillight wires, as shown in figure #6.

Box Wires	Main Harness
Red	Brown
Green	Green/yellow
Black	Dark Green



ETON America, LLC