



Buyers Agreement Checklist ATV

Place in
Dealer's File
Do NOT send to ETON

As members of the Motor Vehicle industry, our staff and management would like to thank you for your purchase of an E-TON ATV. We sincerely believe you will receive years of enjoyment from this purchase.

As in many recreational activities, accidents can and do occasionally occur. It is for this reason and your understanding of your ATV safety, that we specifically bring the following points to your attention. We ask that you read each point carefully and ask your sales rep if you do not clearly understand any particular points.

Initials

- _____ 1. I have received the owner's manual and agree to read it, especially the safety warnings, before using the ATV. I understand that all riders (adult and children) should wear an approved helmet and all appropriate safety gear whenever riding the ATV.
- _____ 2. I understand that this ATV is subject to all laws of the road, and that many states and localities have additional laws which specifically apply to ATV's.
- _____ 3. I have been instructed in the proper use of the braking and speed managing mechanisms of this ATV unit, and in the use of all quick release mechanisms (wheels, seat post and brakes) as well as any wheel retention devices on this ATV.
- _____ 4. I have been advised on the proper sized ATV unit for my needs, but final selection of this ATV has been my own decision.
- _____ 5. I understand that regular maintenance is required to keep this ATV unit operating properly and that failure to maintain this unit may void the manufacturer's warranty and may result in the ATV becoming unsafe to operate. Regular maintenance includes frequent inspection of all periodical check mechanisms and wheel retention devices. I also understand that maintaining appropriate tire pressure at all times is essential for the safe use of this ATV. The recommended tire pressure is marked on the tire and is also found in the owner's manual.

By initialing each item on the above checklist, I have indicated my complete understanding of these points, and I acknowledge my responsibilities regarding the contents. I also agree to explain the points on this checklist to anyone besides myself who will be using the ATV now and in the future.

X _____ / _____ / _____
Buyer's Signature Date Print Buyer's Name

ETON America, LLC

Warranty Registration and Pre-Delivery Certification

[illegible]

Owners Name

[illegible]

Address

[illegible]

City

--	--

State

--	--	--	--	--

Zip

			■				■			
--	--	--	---	--	--	--	---	--	--	--

(Area Code)

Phone

Invoice No.		Invoice Date
Model	Color	Delivery Date
VIN /Frame No. R (or place label here)		
Engine No. (Not required)		

Dealer No. ET	
Dealership Name	
Address	
City State Zip	
Phone	Fax
Sales Persons Name (Please Print)	

Pre-Delivery Certification

By signing below, I hereby certify that prior to delivery to the first consumer, Set-Up and Pre-Delivery Servicing was performed on this unit in accordance with instructions contained in the Set-Up and Pre-Delivery Checklist. I also hereby certify that a copy of the Pre-Delivery Checklist was completed and on file in the consumers file for this unit and that the set-up and Pre-Delivery checklist was completed by a trained technician. I hereby certify that the consumer has been made aware of skill training (safety) materials, courses and the importance of training for skill improvement. The consumer has also completed and signed the Buyers Agreement Checklist and a copy has been placed in the consumer's file for this unit. ETON products must be set-up by an authorized ETON Dealer. Any ETON product sold without proper setup by authorized ETON Dealer will void the warranty.

Sales Managers Signature

Date _____

(Tear at perforation)

Register On-Line at
www.etonamerica.com

or Fax form to ETON at 864-278-9590

Owner's Identification Card

Invoice No.	Invoice Date	VIN /Frame No. R
Invoice Amount	Delivery Date	
Model	Color	(or place label here) Engine No. (Not required)
Owner's Name		
Address		
City State Zip		Phone



To be completed by Authorized ETON Dealership

Place in
Dealer's File
Do NOT send to ETON

ID Card to be given to Customer

ETON America Setup and Pre-Delivery Check List

Dealer Name _____ Dealer No. **ET** _____

Address _____ City _____ State _____ Zip _____

Model	Color
VIN/Frame NO. (Place label here) R	Engine No.
Setup Date	Delivery Date
Setup Tech	Sales Person

I certify that this unit has been setup according to the instructions supplied with the unit, including those items checked below.

Tech Name _____

Signature _____

Q/C Checked by: _____

Setup Check List ☒

- | | | |
|--|--|--|
| <input type="checkbox"/> Unit uncrated | <input type="checkbox"/> Handlebar cover installed | <input type="checkbox"/> Caps and lids installed |
| <input type="checkbox"/> Parts inventory Completed | <input type="checkbox"/> Cable, wire and hose routing checked | <input type="checkbox"/> Seat installed and latch checked |
| <input type="checkbox"/> Wheels installed, torqued & pinned | <input type="checkbox"/> Fuel Cap breather tube installed | <input type="checkbox"/> Owners manual, Tool kit stored |
| <input type="checkbox"/> Rubber covers installed & bolts tightened | <input type="checkbox"/> Throttle adjustment bolt checked | <input type="checkbox"/> Racks & bumpers installed (as required) |
| <input type="checkbox"/> Tires inflated to proper pressure | <input type="checkbox"/> Idle speed adjustment verified | |
| <input type="checkbox"/> Handle bar positioned & torqued | <input type="checkbox"/> All nuts and fasteners checked for proper tightness | |

Pre-Delivery Service Inspection Check List ☒

<input type="checkbox"/> Battery; Electrolyte added and serviced accordingly. Charge checked. **NOTE: Battery does not need to be charged unless the charge check indicates a low charge condition.	<input type="checkbox"/> Fuel system checked 1. Fuel tank inspected and filled 2. (50:1 fuel/oil mixture for 2 cycle engines on first tank) 3. Fuel filter inspected 4. System checked for leaks 5. Cable routing checked	<input type="checkbox"/> Test Ride completed 1. Transmission operation 2. Brakes operation & performance 3. Throttle operation 4. Handling, Steering & Handlebars 5. Engine idle and acceleration
<input type="checkbox"/> Electrical system check 1. Head lights / tail lights 2. Indicator lamps 3. Engine stop switch 4. Safety stop switch (Tether) 5. Remote stop system 6. Charging system 7. Starter motor operation	<input type="checkbox"/> Throttle operations 1. Return from full open to idle 2. Free lever travel 3. Throttle stop bolt setting <input type="checkbox"/> Air filter for uniform oil distribution <input type="checkbox"/> Brake lever adjustment & operation <input type="checkbox"/> Kick starter handle onboard/Installed	<input type="checkbox"/> Checked for oil and fuel leaks <input type="checkbox"/> Drive chain adjustment and slack <input type="checkbox"/> Engine oil tank level checked filled with high grade 2 cycle injector oil <input type="checkbox"/> Owner's manual and tool kit onboard <input type="checkbox"/> Wheel caps installed

I certify that this unit has had the Pre-Delivery inspection and Service completed. This inspection was preformed in accordance with the setup instructions supplied with the unit and those items checked above.

Tech / Sales Rep: _____ Date: _____ Q/C Check by: _____ Date: _____



ETON Yukon II (CXL-150) Setup Instructions

1. Uncrate ATV



2. Inventory Parts Package (see Check List)



3. Prep battery by adding electrolyte. (About 1 hour for battery to come to full charge. **DO NOT** Put on charger.)



4. Attach tie rod ends using 10mm Lock nut (2). Torque to 25flb and install 3/4" cotter keys (2).



5. Align brake backing plate by placing alignment hole over locator pin on the spindle assembly.

6. Install front bumper using 8x16mm bolts (4). Torque to 16flb



7. Install head light assemblies to front bumper using 8mm flange nut and spring washer. Torque to 5flb.

8. Connect head light connector to wire harness and route wires down bumper supports using zip ties (4).



9. Carefully remove front fender hole plugs at perforations. (Punch out using a screwdriver)

10. Install front rack assembly using 8x16mm bolts (4). Torque to 16flb.





11. Install rear bar assembly using 8x16mm bolts and lock washers (4). Torque to 16flb.

12. Connect rear tail / brake light wire to harness.



13. Install rear fender flares using 6x18mm bolts and 6mm nut (10).

14. Install rear rack assembly using 8x16mm bolts (2), 8x40mm (2), rear rack collars (2), and 8mm flange nuts (2). Torque to 16flb.

15. Inflate front and rear tires to 4psi



16. Check torque of rear axle nuts. Torque to 45flb.



17. Install front and rear wheels. Note rotation arrows on tires when installing.

18. Attach front wheels using
 a. Front wheel Assembly
 b. 15x24x5t front wheel washer (2),
 c. 14mm castle nut (2). Torque to 44flb.
 d. Insert 1¼" cotter key (2)

19. Attach rear wheels using
 a. 15x24x5t washer (2),
 b. wheel assembly
 c. 40x14x4.5t washer (2),
 d. 14mm castle nut (2). Torque to 44flb.



20. Insert 1¼" cotter key (2).

21. Install wheel hub caps over wheel nuts. (4).



22. Position handlebar assembly and tighten the 5mm hex head socket bolt to secure. (Caution: Do not over tighten.)



23. Check engine oil level. Fill to full line using SAE 30w engine oil.



24. Remove seat by pulling seat latch under rear fender.



25. Install battery. Attach red lead to positive terminal and black lead to negative terminal.
26. Secure battery with rubber battery strap.
27. Check under seat storage compartment for tool kit and place owner's manual in compartment.
28. Replace seat.



29. Turn on ignition key, check gear shift shaft position indicator lights by moving shaft from reverse to forward position. (Reverse position red light, neutral green light, and forward blue light.)

30. Remove fuel cap and fill tank with gasoline. (At least 89 octane)

31. Replace fuel cap and install breather tube through hole in instrument panel below indicator lights.



32. Check fuel system for leaks.
33. Lock parking brake using right hand lever and lock button.



34. Move gear shift shaft into neutral position.



35. Move engine stop switch to on position.
36. Turn ignition key to on position.
37. While holding the left hand brake lever in, start unit by pressing yellow starter button. (DO NOT crank starter motor more than 15 seconds)
38. Allow unit to warm up for 4-5 minutes.
39. Check idle speed. Adjust to run at 1500-1800rpm.
40. Test ride unit.
41. Check for any loose bolts and fasteners.
42. Complete set-up form check list.

Yukon II CXL-150 Parts Packing List

Qty	Item No.	Description
1	651.006	E-Ton Setup Instructions
4	650.424	Spring Washer (08)
14	650.294	Flange Bolt (M8 X 16)
2	700.273	Flange Bolt (M8x40)
4	800.560	Checked Flange Nut (8mm)
2	650.753	Rear Rack Collar
2	650.843	Rubber Hub Cap
2	650.353	Rubber Hub Cap
2	650.255	Self-Locking Flange Nut (M10)
2	650.339	Cotter Pin (1/8 x 1)
2	651.105	Head Light Assembly
2	650.424	Spring Washer (08)
2	650.046	Flange Nut (M8)
2		Wire Ties
10	650.943	Button Head Screw (M6x18)
10	800.504	Flange Nut, (M6)
1	800.429	Rear Bar Assembly
1	800.458	Owner's Manual Yukon
1	800.529	Tire Pressure Gage
1	800.453	Battery (GTX9-BS)
2		Front Wheel & Tire assembly
2	650.368	Wheel Axle Washer, (40x14x4.5)
4	800.291	Washer (15x24x2.3)
4	800.525	Castle Nut, (M14)
4	650.352	Cotter Pin (1/8 x 1-1/2)
2		Rear Wheel & Tire Assembly
1	800.370	Fender Flare, (RH)
1	800.371	Fender Flare, (LH)
1	810.205	Front Bumper (CXL)
1	810.204	Front Rack (CXL)
1	810.206	Rear Rack (CXL)
1		Setup Instruction sheets
1		Unit Folder containing:
		Buyer agreement
		Setup Checklist / PDI form
		Registration Form
		VIN Labels

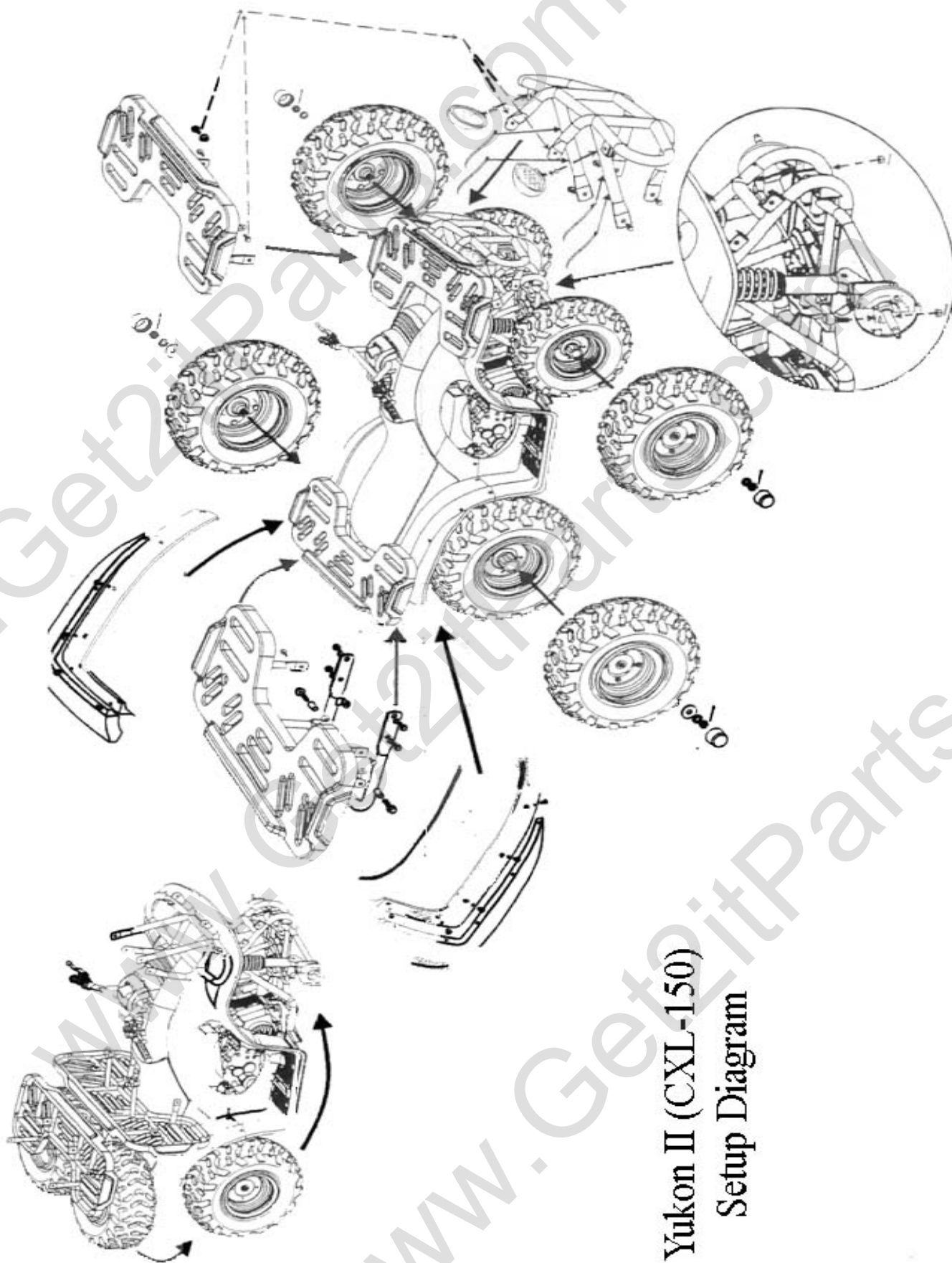

Yukon II (CXL-150)
Setup Diagram